

COVID-19 Study Instructions



Registration ID



Kit Barcode

You will need to reference these ID codes throughout the study.

Please complete all steps as directed. Do not throw away any items before starting, including the packaging.

Let's get started!

STEP 1

To find out who in your household should take the enclosed tests, complete a questionnaire at:

Please see survey link in the printed instructions in your kit.

It will take approximately 15-20 minutes. **If you do not have internet access, or need assistance call: 1 (855) 263-0442**



The study will be open for a limited time. Once the questionnaire is complete, the selected household member should take the tests as soon as possible. This person needs to do both tests.

The tests look for active COVID-19 infection as well as for antibodies that indicate if someone has had COVID-19. It is possible to have COVID-19 without showing symptoms. Results will be provided as part of participation in the study.

A \$40 e-gift card will be provided for completion of the questionnaire and return of the test kit.



The questionnaire must be completed and the test kit registered to get test results.
Test kit registration occurs at the end of the questionnaire.

Are you the person identified in the questionnaire to take the tests?

Turn the page for detailed instructions for taking the tests.
Allow 30 minutes for this next part.



STEP 2**Nasal Swab**

Complete the questionnaire
before taking the tests!



Watch a video of someone doing a nasal swab at covidvu.emory.edu/videos

Open the **blue bag** and place all the contents on a clean dry surface:

Nasal Swab • Collection Tube with Non-toxic Liquid • Bio-hazard Bag with Absorbent Sheet

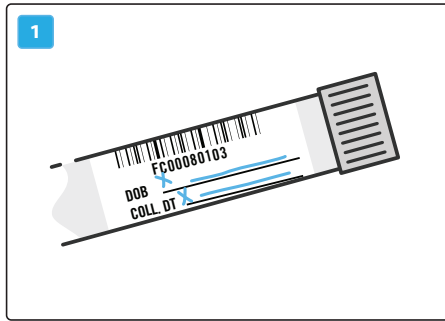

Write your date of birth and today's date in MM/DD/YYYY format on the **barcode sticker on the collection tube**.



Wash your hands with warm water and mild soap. Dry your hands.

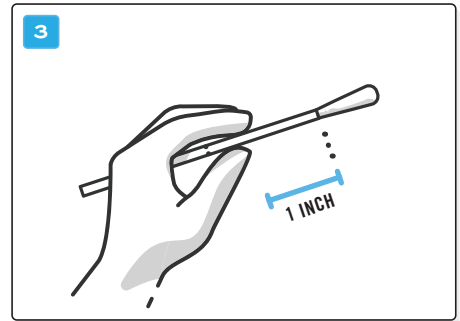

Remove the **nasal swab** from its wrapper. Hold the swab about 1 inch below the cotton tip. Do not touch the cotton tip or put the swab down.

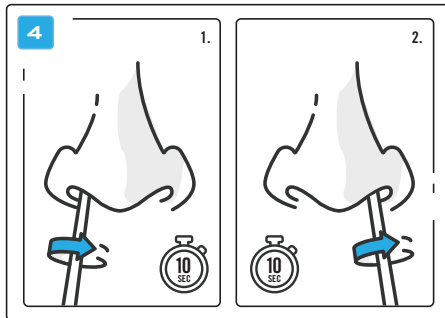

Insert the swab **half an inch** into your right nostril. Scrub the walls of your nostril, rotating the swab for 10 seconds.

Repeat in your left nostril with the same swab. Do not put the swab down.

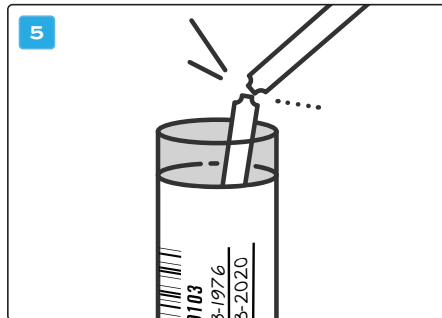

While continuing to hold the swab, twist the cap off the collection tube being careful not to spill the liquid.

Put the swab in the tube and break off at the **indentation mark** by bending against the edge. Twist the cap on the tube until it is tightly closed.



Place the capped and labeled collection tube into the **bio-hazard bag** and seal it. Make sure the absorbent sheet stays in the bag.

Continue to step 3: blood spot collection.



STEP 3

Blood Spot Collection



Complete the questionnaire before taking the tests!



Watch a video of someone doing a blood spot collection at covidvu.emory.edu/videos

Open the **green bag** and place all the contents on a clean dry surface:

Collection Card • Lancets • Alcohol Wipes • Band-Aids & Gauze Pads • Bio-hazard Bag w/ Silica Gel Packet

1

Allow to dry for 15 minutes before closing cover

↑ Tuck Cover Here ↑

Name Jane Smith

Date of birth (MM/DD/YYYY) 05/13/1976

Date of collection (MM/DD/YYYY) 06-23-2020

Write your date of birth and today's date in MM/DD/YYYY format on the **collection card**. Be careful not to touch the circles.



Wash your hands with warm water and soap. Dry your hands and shake them vigorously for 15 seconds to encourage blood flow.

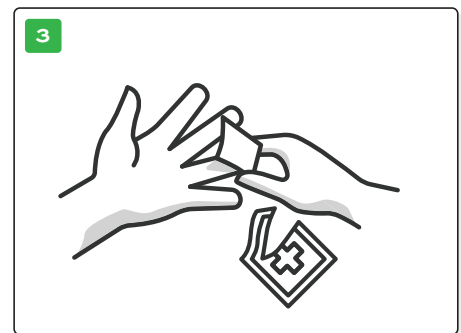

Use an **alcohol wipe** to clean the fingertip that you will prick. Use the middle or ring finger of the hand you use less often.

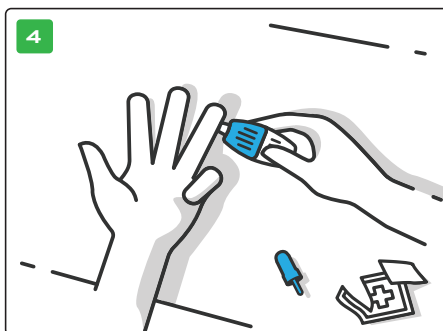

Twist the cap off a **lancet**. With your hand on a solid surface, press the **tip** firmly into the **side** of your fingertip until you hear a click. You will feel a light prick.

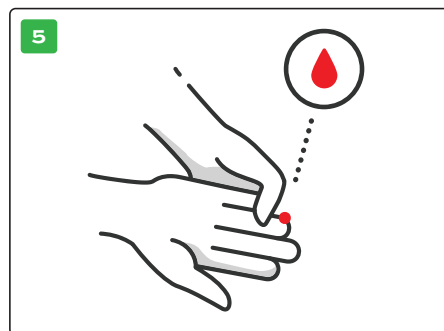

Holding your finger below your heart, continuously massage from the base to the tip **until a blood drop forms**.

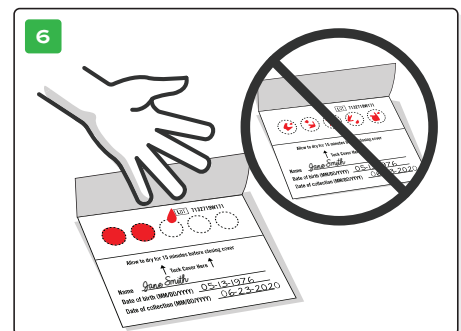

Fill all the circles completely with drops of blood. **Do not press your finger to the card**. It's okay if some blood extends beyond the lines. If needed, prick another finger using a new lancet.

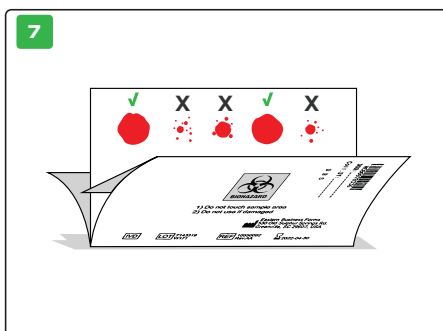

When all the circles are filled, check the **back of the sheet** to make sure the blood has come through. If not, add more blood drops to the front. More blood is better. When finished use the gauze and band-aids.

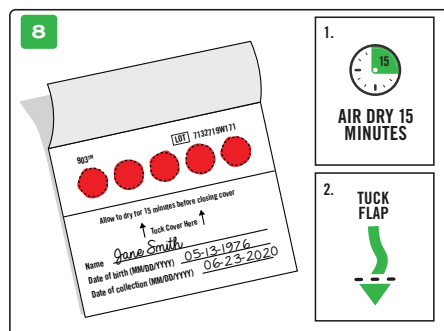

Allow the card to **air dry for 15 minutes** before closing the cover. **Do not heat or blow dry the card** as it will damage the sample.

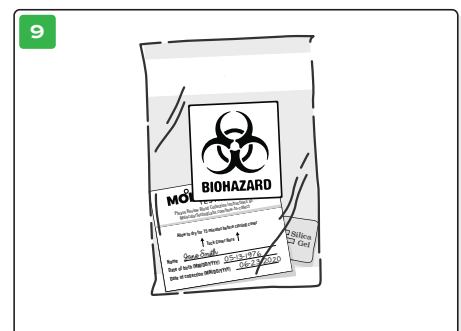

Put the card into the **bio-hazard bag** and seal it. Make sure the **silica gel packet** stays in the bag.

Turn the page for step 4: returning the tests.



STEP 4

Within 48 hours of completing the tests, use the pre-paid USPS Priority Mail envelope to return the test kit to the lab.



Watch a video of someone mailing back a test kit at covidvu.emory.edu/videos

- Put the two **sealed bio-hazard bags** with your completed tests back into the **test kit box**. You do not need to re-attach the paper sleeve.

Save this instruction sheet as it has your study identification numbers. Any other remaining items, including the lancets, can be thrown away in your household trash.

- Put the box with the bio-hazard bags into the pre-paid **USPS Priority Mail envelope**. It will be a tight fit. Do your best to seal the envelope completely. Additional tape may be used if needed.
- Get the envelope in the mail **within 48 hours** of completing the tests. You can put it in your outgoing mail, give it to your mail carrier, drop it off at a U.S. post office, or put it in a U.S. post box.

You can also go online to schedule a free pickup at USPS.com. Click on the “Mail & Ship” tab at the top of the page, select “Schedule A Pick Up,” and provide the requested information. Select “pick up during regular delivery \$0.00,” “Priority Mail” (not “Priority Express Mail”) and enter 1 pound for the weight.

If you experience any problems or delays in mailing back your tests, call **1 (855) 263-0442**

- When your tests are received at the lab, you will get an email from Tango Card, email address noreply@tangocard.com, to redeem your \$40 e-gift card. The questionnaire in step 1 must be completed to receive payment.



Results are typically available within 1 week after the test kit is received at the lab. You will be notified when your results are ready.

Your test kit must be registered to get your results.

This study is being done for research purposes. If you are experiencing any health concerns, consult a medical provider.